

EXPLORE WITH PURPOSE

# BUGIS LIVEABOARD

KOMODO TO WAKATOBI (ACROSS THE FLORES SEA)

*by Nomad Archipelago*



## PRICING AND SCHEDULE

**USD 4,400 /person/trip**



- 📍 Departure & arrival check in and out time : **10 am**
- 📍 Departure & arrival Port : **Labuan Bajo to Kendari**

### *What's Included:*

- ✓ Accommodations shared cabins equipped with double bed (140\*200 cm) and single bunk bed (90 \*200 cm)
- ✓ Stand-up paddle board
- ✓ Kayak Snorkeling gears
- ✓ Land excursions according to the safari program
- ✓ Three meals/day and snacks
- ✓ Water, Tea, Coffee, Softdrinks
- ✓ Multilinguals guides on board (English & Indonesian)
- ✓ Transfer from/to embarkation/disembarkation airport

### *What's Excluded:*

- ☒ Harbor and Park Fees **USD. 200/pers/trip**
- ☒ Alcoholic Beverage
- ☒ Travel Insurance
- ☒ Transfer from hotel
- ☒ Onboard or local purchases
- ☒ Fuel surcharge (if any)
- ☒ Single Surcharge plus 75% from the rate
- ☒ Crew and Cruise Director gratuities (Tips on board recommended 5% to 10% of published rates)

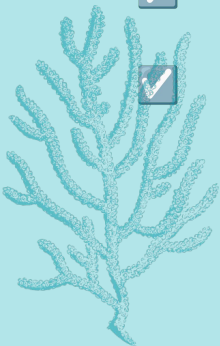



## ABOUT

# Komodo to Wakatobi: Across the Flores Sea

*This voyage is tailored for the inquisitive and avid adventurer. We'll leave behind the bustle and bustle of modern life to immerse ourselves in a world of quiet villages, aquamarine lagoons and the remote atolls of the Flores Sea.*

From the dry and hilly islands of the Komodo National Park where the largest lizards on earth roam, we'll sail north to the little known islands separating Flores from Sulawesi. This is the land of the Bajo, also referred to as "sea gypsies", a sea-faring people whose way of life has little changed in the course of history, living in houses on stilts by the shore.

**We'll also visit two additional national parks,** in Wakatobi and Taka Bonerate, part of the coral triangle, the richest underwater ecosystem in the world where snorkelling and diving will be an experience of a lifetime.



## ABOUT

# Why Travel with Us

### *Sustainability in mind*

We strive to limit our impact and contribute to the environment while benefiting the local communities.

### *Master the art of slow travel*

Discover authentic experiences with our 'slow travel' philosophy. Live the destination, and not just pass by.

### *Built from experience*

Our boat, choice of destinations and itineraries are the brainchildren of our founders' 30 years of experience and knowledge of the industry and the country.

### *Intimate & cozy with top notch service*

Our 8-guest boat the Bugis is perfect for a charter among family, friends, or a shared trip with like minded people. Our 1:1 crew to guest ensures a top notch service and cruising experience on board.

### *Give back*

Our profit goes to financing our NGO Nomad Plastic's efforts to mitigate plastic pollution, protect marine areas, and create jobs in the process.





THE BOAT | BUGIS LIVEBOARD

# Available Activities



Board Games



Snorkeling



Kayaking



Stand Up  
Paddleboards



BBQ



Fishing



Alcoholic  
Beverages\*



Yoga

\*Additional charges apply.



[WWW.NOMADARCHIPELAGO.COM](http://WWW.NOMADARCHIPELAGO.COM)



# ACROSS THE FLORES SEA 14D/13N ITINERARY

# Komodo to Wakatobi

*We propose the following itinerary which adheres to our 'slow travel' philosophy. Note that this itinerary is highly recommended but can be modified to suit your taste and needs.*

Highlights: Discover Komodo's top highlights, cross the untouched Flores Sea, explore the world's third biggest atoll, snorkel or dive at Indonesia's hidden gems, and meet the Bajaus.



## *Day 1*

Upon arrival at Labuan bajo airport, transfer to the harbor where we board our boat, the BUGIS. We'll sail for one hours while your cruise director gives you a general briefing to familiarize you with the vessel and our safety procedures.

We make a swim along the nice beach of Kelor island. Then we trekking through the monsoon forests of Rinca island, hoping to catch a glimpse of the elusive Komodo dragon.





## Day 2

Today will be a day dedicated to the wonderful underwater world of Komodo National Park. With a bit of luck, we might be able to observe manta rays, turtles, and other colorful fish. In the late afternoon, we will depart for the Takabonerate atoll.



## Day 3

After a night of navigation, we arrive at Bonerate island, in the middle of the Flores Sea. We visit the main village: sandy streets, traditional houses built on stilts and elegant Lambo boats being built on the beach. Midday, we cross the narrow strait to the eastern tip of Kalao island and anchor along a spectacular beach. Snorkeling on a nearby reef, hike to the nearby village. Aperero on the beach at sunset and quite night at anchor.







## *Days 4, 5 and 6*

We spend three full days exploring the many islands of the Taka Bonerate National Park, some inhabited, most empty. There will be plenty of beach combing, snorkeling, zodiac exploration in lagoon, visits villages with hordes of children in tow, meeting the locals and of course beach BBQ on remote beaches.



## *Days 7*

With its high cliffs towering over a heavenly beach lined with coconut trees, Batuata is definitely one of the most scenic island of the region. After setting foot ashore, we pay respect to the local Chief, ask for permission to go around and see the island. We visit the local school, hear the children singing the latest local hits. This is truly a remote place, far away from other islands and you will definitely enjoy the remoteness of it. Late afternoon sail towards Wakatobi.



## Day 8 & 9

We will drop the anchor early morning at the southern tip of Hoga island, nearby Kaledupa Island. Fringed by mangrove forest and beaches shaded by coconut trees, those islands have a lot to offer for the two days we'll spend there. A visit to a Bajo village entirely built on stilts above the sea is a must. In the past these `sea gypsies` were more nomadic, living on their boats. Today they live more sedentarily in houses on stilts but they still rely



## Day 10

After a few hours of navigation at dawn, we reach the island of Wangi Wangi. First, we will visit Bajo Mola: the very first bajo village in the island of Wangi Wangi settled down 65 years ago. Please join our crew for the shopping to market to stock up fresh produces. After a snorkeling session, close to the boat, we hoist the anchor for the night passage to Saponda islands.



## Day 11

For the last day in paradise, we will start with a very nice snorkeling session. After the visit of the village, we will raise the anchor to a deserted island. Late evening, we sail to Kendari, our final destination.



## Day 12

After breakfast we say goodbye to captain and crew of the BUGIS and we will transfer you to the airport.







THE BOAT | BUGIS LIVEABOARD

# Bugis Liveaboard

*Built in 2022 our boat the Bugis was conceived for our guests' utmost comfort, fun, and safety as well as sustainability as its main building block.*



4 Cabins for 8  
to 12 Guests



9 Crew Members

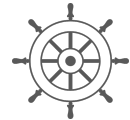

Length / Width  
27.2 m / 6.2 m

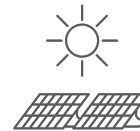

Solar Powered



Sustainable  
Practices



Snorkeler



Spacious  
Social Areas



Large Tender



State of the Art  
Teak Wood  
Finishes



[WWW.NOMADARCHIPELAGO.COM](http://WWW.NOMADARCHIPELAGO.COM)

# The Cabins

*There are 4 double cabins with a berth on top, allowing versatile rooming options. Whether you travel with your friends or family—we've got you covered.*



Size 8m2



Double Bed with a Bunk



Private Bathroom

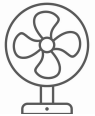

Electric Fan

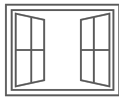

Large Window



Eco-Friendly Toiletries



Towels



Daily Cleaning

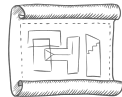

Main Deck Only (Well-Insulated)





THE BOAT | BUGIS LIVEBOARD

## Social Areas

*We have two spacious social areas, one on the main deck and the other on the upper deck, with an open 'wall-less' concept that offers full panoramic views.*

On the main deck, we have a shaded 30 sqm social/dining area where guests can relax, dine, drink, play board games, and more.

On the upper deck, we have a semi-covered 45 sqm area equipped with a bar and an ample open space with plenty of room to do yoga, relax, sunbathe, sleep under the stars or even party at night. You name it!



[WWW.NOMADARCHIPELAGO.COM](http://WWW.NOMADARCHIPELAGO.COM)

## THE BOAT | BUGIS LIVEABOARD | SPECIFICATIONS

Length & Beam	27, 2 m (90 ft) x 6.2 m (20 ft)
Draft	2 m (6,5 ft)
Accomodations	4 double bed cabins with berths/8 guests
Material	Iron wood (hull) and teak
Crew	9
Year Built	2022
Engine	Mitsubishi 6D22 - 220 HP
Speed	8 knots
Generators	Mitsubishi 40 Kw + 15 Kw
Solar Panels	20 x 0,540 kWh = 10,80 kWh
Lithium Batteries	8 x 3,5 kWh = 28 kWh
Voltage	220 Volts
Tender boat	1 Zodiac aluminium hull 5,5m x 2,2m
Compressors	Alkin W31
Electronics	GPS, chart plotter, Depth sounder, Radar
Watermaker	NRC 8000 liters/day

### Side View

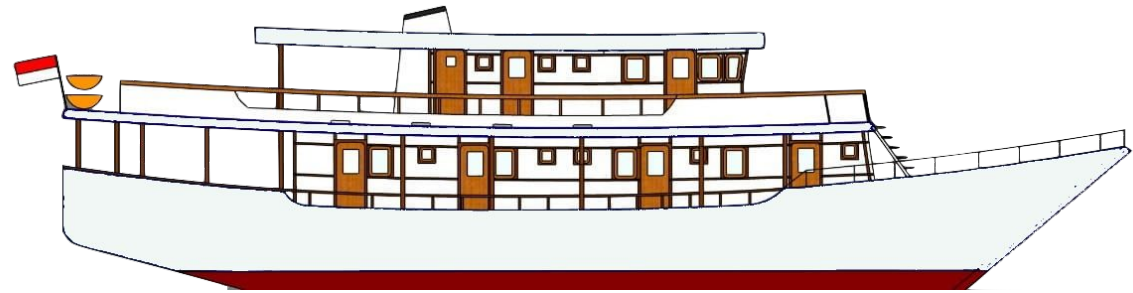

### Lower Deck

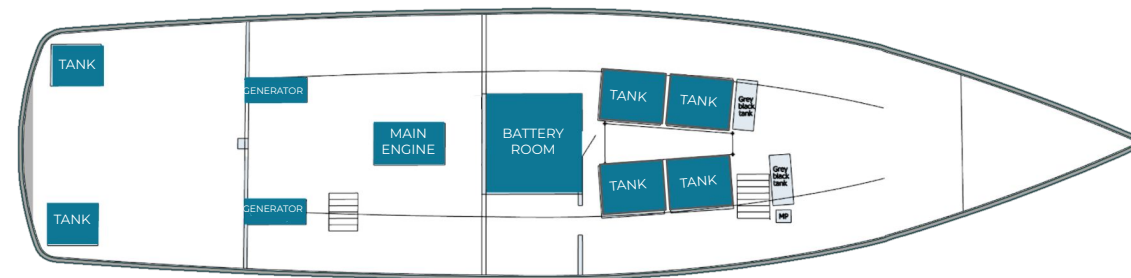



THE BOAT | BUGIS LIVEBOARD | DECK PLAN

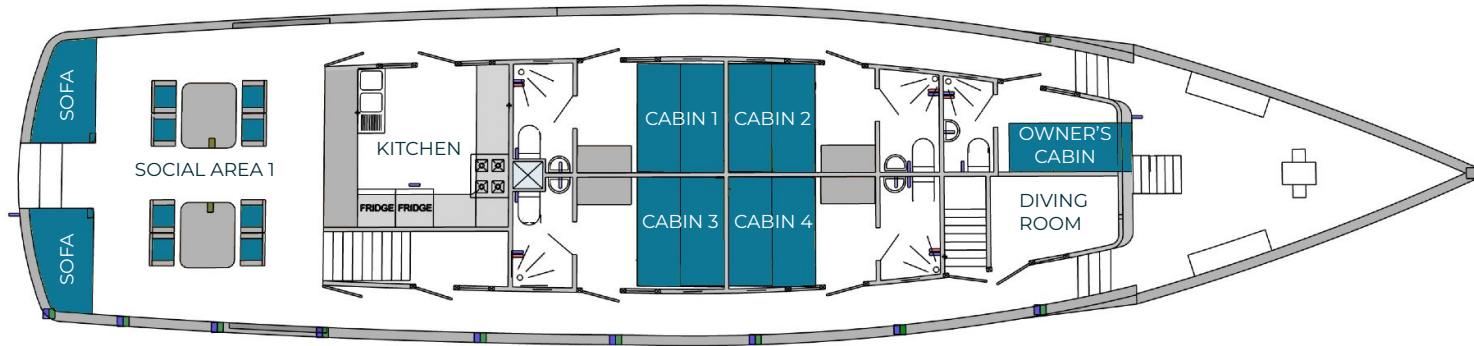

Main Deck

- 4 guest cabins
- Kitchen
- Social and dining area
- Owner cabin
- Diving room

Upper Deck

- Crew cabins
- 2nd semi-shaded social area with a bar

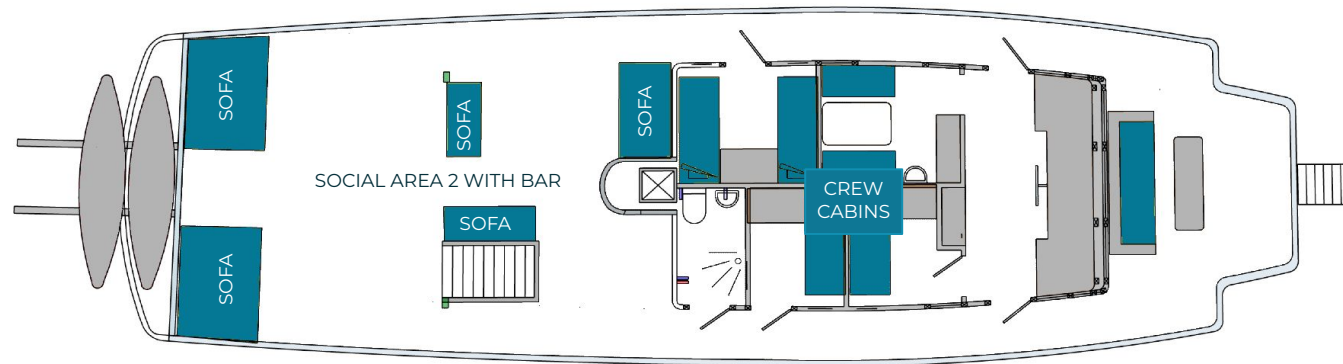



THE BOAT | BUGIS LIVEBOARD

## Low Carbon Footprint

*With over 20 x 550w solar panels, we'll be running our boat on solar power as much as possible.*

Not only does this greatly reduce our carbon footprint, you will also enjoy not having buzzing diesel generators all the time.

## Embrace the serenity moment on board

*Expect a peaceful ambiance aboard and quiet nights with the sounds of crashing waves to lull you to sleep.*

We will only activate the generators when absolutely necessary, ensuring your ultimate onboard experience remains undisturbed



[WWW.NOMADARCHIPELAGO.COM](http://WWW.NOMADARCHIPELAGO.COM)





THE BOAT | BUGIS LIVEBOARD

## Embrace the breeze of the tropical sea

*Apart from the problematic fossil fuel electricity that powers ACs, most refrigerants are also known to deplete the ozone and contribute to global warming.*

This led us to decide not to have any ACs on board.

Worry not, with its open space and wall-less concept, this will always have the air freely sweep all over the area onboard. And the facts that the median temperature at sea is on average 3-5 degrees Celsius below the temperature on land, due to the cooling effect of the sea breeze.

Also, our cabins are all located on the main deck—well insulated and protected from direct sun exposure—with electric fans and large windows that allow fresh and natural cooling.

You will be surprised how comfortable you can be with no AC's.



[WWW.NOMADARCHIPELAGO.COM](http://WWW.NOMADARCHIPELAGO.COM)



BOOKING

## Contact Us!

*We can't wait to hear from you!*



[nomadarchipelago.com](https://nomadarchipelago.com)



[hello@nomadarchipelago.com](mailto:hello@nomadarchipelago.com)



+62-821-4736-8360



[@nomadarchipelago](https://www.facebook.com/nomadarchipelago)



[@nomadarchipelago](https://www.instagram.com/nomadarchipelago)

**LinkedIn**

[nomadarchipelago](https://www.linkedin.com/company/nomadarchipelago)



[WWW.NOMADARCHIPELAGO.COM](https://www.nomadarchipelago.com)