

EXPLORE WITH PURPOSE

BUGIS LIVEABOARD

BANGGAI ARCHIPELAGO (LUWUK TO LUWUK) 6N/7D

by Nomad Archipelago



NOMAD
ARCHIPELAGO



WWW.NOMADARCHIPELAGO.COM

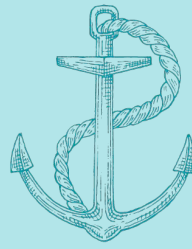

\$ 2,400 /person/trip (excl. Harbor and park fees)

What's Included:

- Accommodations shared cabins equipped with double bed (140*200 cm) and single bunk bed (90 *200 cm)
- Stand-up paddle board
- Kayak
- Yoga Mat
- Fishing Gear
- Snorkeling gears
- Land excursions according to the safari program
- Three meals/day and snacks
- Water, Tea, Coffee, Softdrink
- Multilinguals guides on board (English & Indonesian)
- Transfer from/to embarkation/disembarkation airport

What's Excluded:

- Harbor and Park Fees **USD. 200/pers/trip**
- Alcoholic Beverage
- Travel Insurance
- Transfer from hotel
- Onboard or local purchases
- Fuel surcharge (if any)
- Single Surcharge plus 75% from the rate
- Diving equipment
- Diving session
- Passenger surcharge
- Crew and Cruise Director gratuities (Tips on board recommended 5% to 10% of published rates)

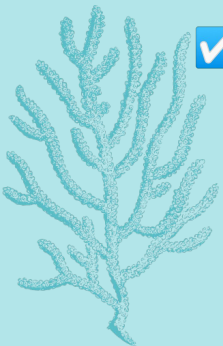



ABOUT

Banggai Archipelago

Located in the far eastern tip of Central Sulawesi, this wild paradise hosts many wonders above and under the sea.

The Banggai Archipelago is located to the east of Central Sulawesi Province. It consists of two main islands with a string of small islands to the south that we will explore.

Like many paradise islands, this part of Sulawesi is tough to get to, making liveaboards the best way to explore the area.

On these small islands live Bugis and Bajau communities, known as sea nomads. Most of these families live permanently on the main islands, but they have built small houses above the lagoon to stay there during the fishing season. We will go meet them, listen to their stories, and share some time with them will be one of the highlights of our trip.





THE BOAT | BUGIS LIVEBOARD

Available Activities



Scuba Diving*



Snorkeling



Kayaking



Stand Up
Paddleboards



BBQ



Fishing



Alcoholic
Beverages*



Yoga



Board Games

*Additional charges apply.



WWW.NOMADARCHIPELAGO.COM

ACTIVITIES

Meet the Bajau 'Sea Nomads'

Known for their impressive ability to hold their breath underwater for an impressive period of time due to their larger spleens, the Bajau also possesses a unique traditional way of life.

These communities still live a very traditional lifestyle in small villages with houses built on stilts over the sea, and their livelihood depends entirely on the sea.

Our Banggai cruise will mostly call at small and remote islands where the Bajau people form the majority of the population.

We will take you to some of their villages throughout your trip so that you can get up close and personal with these seafarers, watch them as they demonstrate their supernatural freediving ability, and see how they make their living from the sea.

Be prepared for a once-in-a-lifetime experience with the Bajau!





NOMAD
ARCHIPELAGO

TOMPOTIKA

LUWUK



1 7

BANGGAI
ARCHIPELAGO

TOROPOT

6

BANGGAI ISLAND

BURUNG
ISLAND

2

BOKAN

5

3

4

BANGGAI 7 DAY ITINERARY

SOMBORI
ISLAND

SOUTHEAST
SULAWESI

SAPONDA
ISLAND

PADEA ATOLL

KENDARI



Banggai Archipelago

We propose the following itinerary, which aligns with our "slow travel" philosophy, focusing on local fishing communities, snorkeling in beautiful reefs, and relaxing on lovely beaches. A lot of these little islands are surrounded by a lagoon, and some of them can't be reached when the tide is low. So, the plan might change depending on the tide level.



Highlights:

- The warm hospitality of the Bajau communities
- White sandy beaches & Exceptional snorkeling
- Highly recommended for photographers

NOMAD
ARCHIPELAGO

Day 1

Upon arrival at Luwuk Airport, we will transfer to the harbor where we embark on our vessel, the BUGIS. While sailing, our cruise director will provide a briefing to familiarize you with the vessel and our safety procedures. In the late afternoon, we will make a stop at a charming beach. As night falls, we will weigh anchor to continue our journey along the picturesque coast.



Day 2

On our first day in the archipelago, we'll visit the second protected marine area we support. We'll hop on a Zodiac boat to explore the clear waters around the lagoon of Malapati reef for our first snorkeling adventure. After that, during lunch, the boat will take us to Sidula Island for some beach time and more snorkeling fun.



Day 3

In the morning, we'll reach a small island surrounded by beautiful white-sand beaches and turquoise waters in the Banggai Archipelago atoll. Our day will be filled with snorkeling, swimming, and a barbecue on the lovely beach. In the afternoon, we'll take a short sail to a tiny island to meet a small community called Bajau who live there. We'll enjoy a bonfire with them on the beach as the sun sets.



Day 4

After getting back on board, we'll keep sailing to the next island, where we'll meet the Bugis and Bajau communities on the island of **Nal** and learn about how they connect with each other. We will also have the chance to go snorkeling on a beautiful reef. In the afternoon, we'll set sail for another island to enjoy a beautiful beach and more snorkeling.



This day promises exciting exploration with visits to "Bajo" villages, where you'll likely be the center of attention as it's a place rarely visited by foreigners. In the early morning, weather permitting, we'll be on Toropot Island to explore two picturesque Bajau villages. These communities primarily sustain themselves through the octopus trade and seagrass. The highlight of the day will be snorkeling near the mangroves, offering a chance to spot the endemic "Banggai cardinal fish." We'll also go ashore and visit a traditional village in the interior, witnessing fishermen trading their daily catch.



Day 6

In the northeastern part of Banggai Island, we'll find the most breathtaking beaches in the archipelago. Though we might not get to explore all of them, we'll definitely make a stop under the shade of a tree along the fine sandy shoreline. Here, we can enjoy snorkeling around the superb reef. Additionally, we'll embark on a Zodiac raid to meet the local fishermen. As the sun sets, we'll raise the anchor and head to our final destination, Luwuk.





ITINERARIES

Day 7

We will arrive at the harbour of Luwuk early morning. After breakfast we say farewell to the crew and we will be transferred to the airport for the return flight to Bali.





THE BOAT | BUGIS LIVEBOARD

Bugis Liveaboard

Built in 2022 our boat the Bugis was conceived for our guests' utmost comfort, fun, and safety as well as sustainability as its main building block.



4 Cabins for 8
to 12 Guests



9 Crew Members



Length / Width
27.2 m / 6.2 m

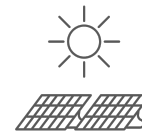

Solar Powered



Sustainable
Practices



Diver & Snorkeler
Friendly

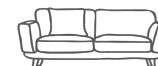

Spacious
Social Areas



Large Tender



State of the Art
Teak Wood
Finishes



WWW.NOMADARCHIPELAGO.COM

The Cabins

There are 4 double cabins with a berth on top, allowing versatile rooming options. Whether you travel with your friends or family—we've got you covered.



Size 8m2



Double Bed with a Bunk



Private Bathroom

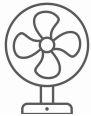

Electric Fan

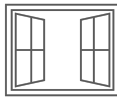

Large Window



Eco-Friendly Toiletries



Towels



Daily Cleaning

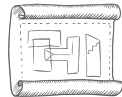

Main Deck Only (Well-Insulated)





THE BOAT | BUGIS LIVEBOARD

Social Areas

We have two spacious social areas, one on the main deck and the other on the upper deck, with an open 'wall-less' concept that offers full panoramic views.

On the main deck, we have a shaded 30 sqm social/dining area where guests can relax, dine, drink, play board games, and more.

On the upper deck, we have a semi-covered 45 sqm area equipped with a bar and an ample open space with plenty of room to do yoga, relax, sunbathe, sleep under the stars or even party at night. You name it!



THE BOAT | BUGIS LIVEABOARD | SPECIFICATIONS

Length & Beam	27, 2 m (90 ft) x 6.2 m (20 ft)
Draft	2 m (6,5 ft)
Accommodations	4 double bed cabins with berths/8 guests
Material	Iron wood (hull) and teak
Crew	9
Year Built	2022
Engine	Mitsubishi 6D22 - 220 HP
Speed	8 knots
Generators	Mitsubishi 40 Kw + 15 Kw
Solar Panels	20 x 0,540 kWh = 10,80 kWh
Lithium Batteries	8 x 3,5 kWh = 28 kWh
Voltage	220 Volts
Tender boat	1 Zodiac aluminium hull 5,5m x 2,2m
Compressors	Alkin W31
Electronics	GPS, chart plotter, Depth sounder, Radar
Watermaker	NRC 8000 liters/day

Side View

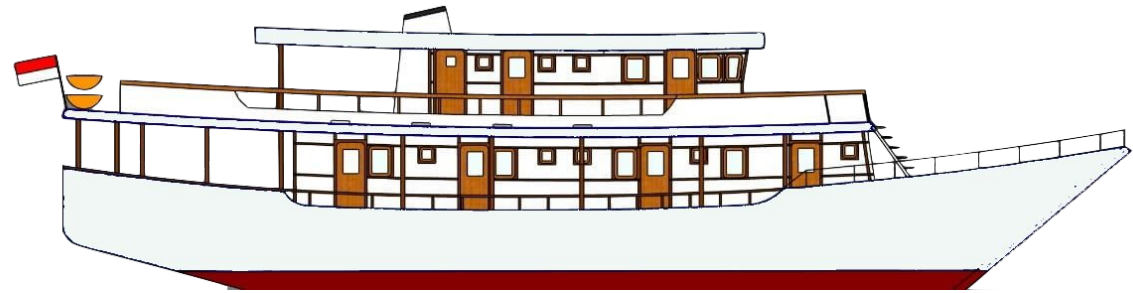

Lower Deck

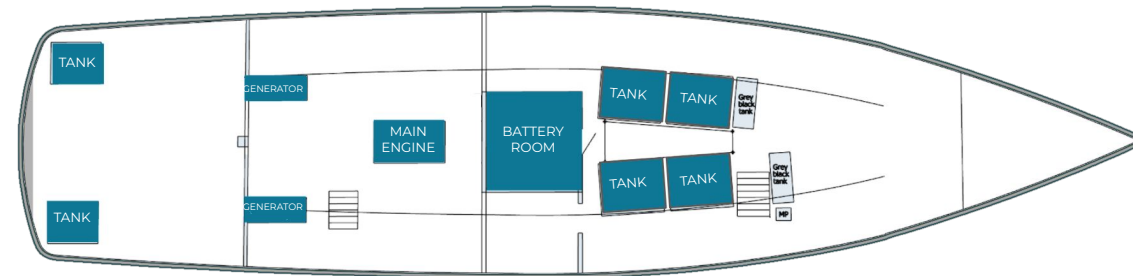



THE BOAT | BUGIS LIVEBOARD

Low Carbon Footprint

With over 20 x 550w solar panels, we'll be running our boat on solar power as much as possible.

Not only does this greatly reduce our carbon footprint, you will also enjoy not having buzzing diesel generators all the time.

No Generator, No Noise

Expect a peaceful ambiance aboard and quiet nights with the sounds of crashing waves to lull you to sleep.

We'll only turn on the generators when absolutely needed and when you're not there.



WWW.NOMADARCHIPELAGO.COM



DESTINATIONS & SCHEDULE

● **DEC - MAR:** RAJA AMPAT

● **MAR - OCT:** KOMODO

● **OCT (CROSSING):** WAKATOBI, TAKA BONERATE & KOMODO

● **NOV - DEC:** SULAWESI, HALMAHERA



 INTERNATIONAL AIRPORT

 DOMESTIC AIRPORT

● ● KOMODO NATIONAL PARK



NOMAD
ARCHIPELAGO



BOOKING & RESERVATION

Contact Us!

We can't wait to hear from you!



nomadarchipelago.com



hello@nomadarchipelago.com



+62-821-4736-8360



[@nomadarchipelago](https://www.facebook.com/nomadarchipelago)



[@nomadarchipelago](https://www.instagram.com/nomadarchipelago)



[nomadarchipelago](https://www.linkedin.com/company/nomadarchipelago)



WWW.NOMADARCHIPELAGO.COM